

INSTALLATION INSTRUCTIONS

1. ENSURE THE APERTURE IS CLEAN AND FREE OF DUST AND DEBRIS.
2. APPLY RYANFIRE MASTIC INTO THE ANNULAR GAP BETWEEN THE PIPE AND THE PLASTERBOARD WALL.
3. WRAP 1 LAYER OF 1000MM WIDE RYANFIRE ROKWRAP TIGHTLY AROUND THE PIPE WITH A 100MM OVERLAP ON THE LONG EDGE. SLIDE THE ROKWRAP UP AGAINST THE SURFACE OF THE WALL.
4. SECURE THE ROKWRAP AROUND THE PIPE USING STEEL CABLE TIES 50MM FROM EACH END, AND AT MINIMUM 150MM CENTRES.
5. SEAL ANY EXPOSED EDGES OF THE ROKWRAP USING FOIL TAPE.
6. APPLY 20X20MM CONE OF RYANFIRE MASTIC TO THE JOINT BETWEEN THE ROKWRAP AND THE WALL.
7. REPEAT THIS PROCESS TO THE OPPOSITE SIDE OF THE WALL.

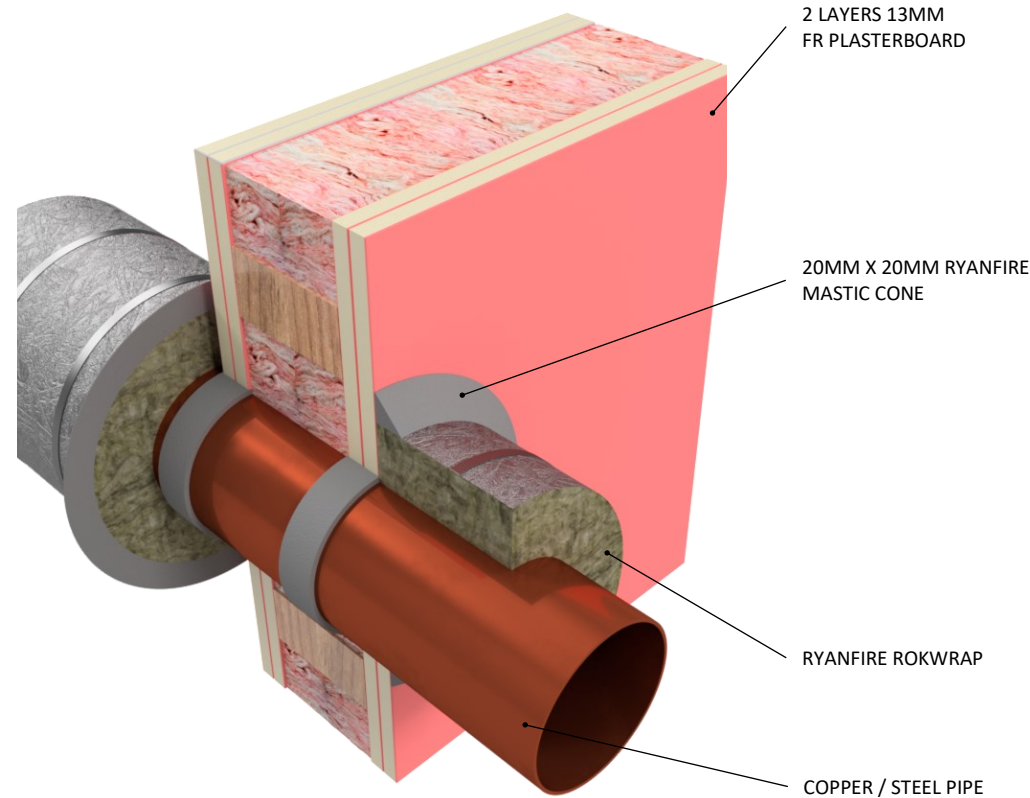

Products:	RYANFIRE ROKWRAP RYANFIRE MASTIC
Approval:	AS 1530.4/AS 4072.1
BK:	253
Ref:	23SFR00083
ID:	C, D
Scenario:	Penetration seal to copper pipes
Services:	Up to Ø100mm copper / steel pipes
Construction:	142mm FR plasterboard / Masonry wall
Fire Integrity:	120 minutes
Fire Resistance:	90 minutes

Web based drawings are for example only. Fire performance of any system is dependant on, but not limited to, size of opening, substrate, if penetrations are passing through, type, size and number. Please refer to Ryanfire technical department for detailed and specific fire performance information.



RYANFIRE Technical Support:
info@ryanfire.co.nz - Tel 09 443 0362

Drawing Title
**Ryanfire Rokwrap to copper / steel pipe
142mm plasterboard wall**

Scale	Date
NTS	January 2024

Drawing Number	Rev
V1.21	1.0

All errors and omissions excepted. The information contained within this drawing is believed to be correct on the date of publication, and is based upon tested and certified solutions. The policy of Ryanfire Products Ltd is one of constant improvement. Installers must ensure that they are following the latest published drawings, test evidence and instructions. Whilst Ryanfire Products Ltd will endeavour to keep its publications up to date, the accuracy of the information contained within this drawing may be affected by pertinent changes in the law or regulatory requirements and alterations or amendments to the specification of the manufactured products. Terms and conditions of sale apply.

Ryanfire Products Ltd owns and has copyright to these drawings. They are to be used only for the purpose for which they were intended and supplied and are not to be sold, transferred or made available for use by a third party. Any misuse of these drawings will result in legal proceedings.