

**INSTALLATION INSTRUCTIONS**

1. CUT THE RYANLITE BOARD TO THE CORRECT SIZE TO FIT AROUND THE STEEL BEAM OR COLUMN. FOR INSTALLATION ON BEAMS THE BOTTOM BOARDS SHOULD BE CUT TO THE SAME WIDTH OF THE FLANGES. BOARDS ON THE SIDES MUST OVERLAP THE BOTTOM LAYER.
2. RYANLITE SHOULD BE FASTENED TO THE STEEL USING 3MM STEEL RYANFIX S-PINS AND LOCK WASHERS. SECURE THE S-PINS USING A PIN NAILER TO FIRE 2 STEEL PINS INTO THE FLANGE. RYANFIRE RECOMMENDS THE RAMSET TRAKFAST™800 GUN.
3. THE PINS SHOULD BE FASTENED MAX 50MM IN FROM EACH JOINT AND MAX DISTANCE BETWEEN FASTENERS IS 360MM.
4. FOR FLANGES WITH A WIDTH OF 180MM OR LESS USE ONE PIN FIXED IN THE CENTRE OF THE BOARD. FOR FLANGES ABOVE 180MM WIDTH USE TWO PINS FIXED 50MM IN FROM EACH EDGE.
5. INSERT A 100MM WIDE BUTT JOINT BOARD BEHIND ANY HORIZONTAL JOINTS IN EACH SIDE BOARD. THIS SHOULD FIT TIGHTLY BETWEEN THE UPPER AND LOWER FLANGES AND BE THE SAME THICKNESS OF THE RYANLITE BEING USED.
6. FIX THE SIDE BOARDS TO THE BUTT JOINT BOARD USING SPIRAL SCREWS. FOR PROFILES WITH A HEIGHT OF 400MM OR LESS USE ONE SPIRAL SCREW FIXED IN THE CENTRE. FOR PROFILES WITH A HEIGHT ABOVE 400MM USE 2 SPIRAL SCREWS FIXED AT THE 1/3 AND 2/3 POINTS.
7. ALL THE EDGES OF THE STEEL MUST BE FULLY COVERED BY RYANLITE AND THERE SHOULD BE NO GAPS OR OPENINGS.
8. APPLY FOIL TAPE TO ALL EXPOSED BOARD EDGES.

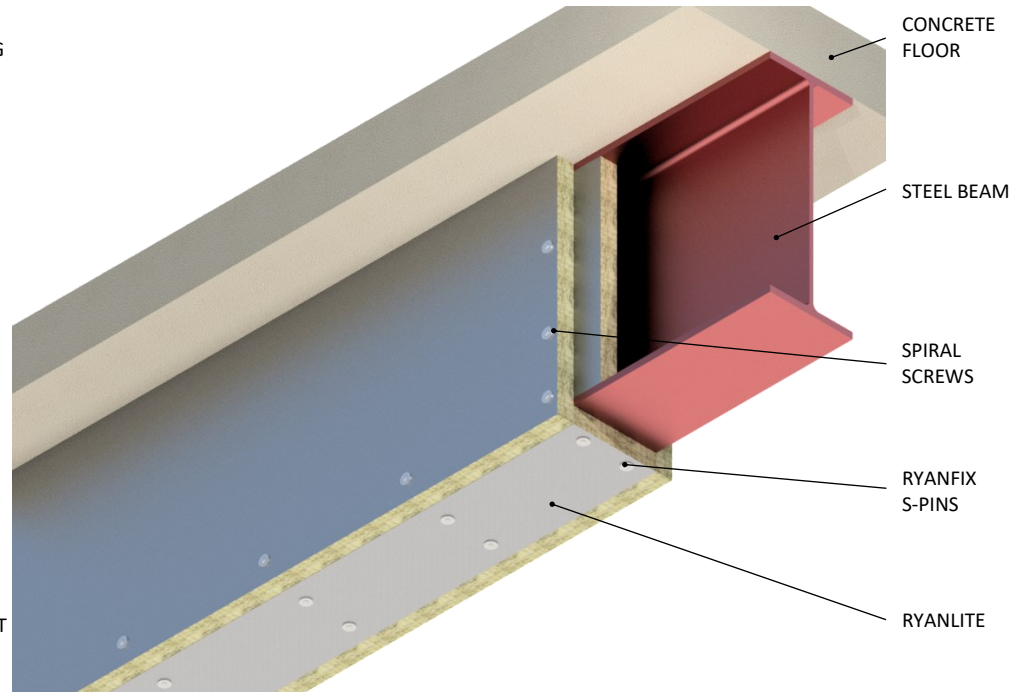

**FOR FULL INSTALLATION INSTRUCTIONS  
PLEASE REFER TO THE RYANLITE  
INSTALLATION GUIDE**

Please note:  
Ryanfire Products Ltd owns and has copyright in these drawings. They are to be used only for the purpose for which they were intended and supplied and are not to be sold, transferred or made available for use by a third party.  
  
Any misuse of these drawings will result in legal proceedings.

All errors and omissions excepted - the information contained within this drawing is believed to be correct on the date of publication, and is based upon tested and certified solutions. The policy of RyanFire Products Ltd is one of constant improvement. Installers must therefore ensure that they are following the latest published drawings, test evidence and instructions. Whilst RyanFire Products Ltd will endeavour to keep its publications up to date, the accuracy of the information contained within this drawing may be affected by pertinent changes in the law or regulatory requirements and alterations or amendments to the specification of the manufactured products. Terms and conditions of sale apply.

RYANFIRE Technical Support: info@ryanfire.co.nz

**Products:** RYANLITE  
RYANFIX S-PINS  
**Approval:** BS 476-21  
**BK:** 90  
**Ref:** FAS 200202

**Scenario:** Structural steel protection  
**Construction:** Loadbearing steel beams/columns

**Beam Size:** Max depth 600mm  
No limit on length

**Fire Resistance:** Up to 240 minutes

*Fire resistance ratings are determined by the section factors (A/V) of the beams / columns and require various thicknesses of Ryanlite. Please contact the Ryanfire technical department for specific details*

Web based drawings are for example only. Fire performance of any system is dependant on, but not limited to size of opening, substrate, if penetrations are passing through, type, size and number. Please refer to Ryanfire technical department for detailed and specific fire performance information.



Client

Job Title

Drawing Title

**Ryanlite Steel Protection Board  
Structural steel encasement**

Scale	Date
<b>NTS</b>	<b>July 2021</b>
Sheet Size	Drawn By
<b>A3</b>	
Drawing Number	Rev
<b>V66</b>	<b>5.0</b>