

INSTALLATION INSTRUCTIONS

1. ENSURE THE APERTURE IS CLEAN AND FREE OF DEBRIS AND REMOVE DUST FROM SURFACES REQUIRING INSTALLATION.
2. CUT 13MM FIRE RATED PLASTERBOARD TO THE REQUIRED SIZE AND SHAPE, ENSURING THE PATRESS WILL OVERLAP THE PLASTERBOARD 75MM AROUND THE OPENING.
3. APPLY INTUMASTIC (WHITE) TO PLASTERBOARD WHERE THE PLASTERBOARD PATRESS IS TO BE FITTED.
4. FIRMLY PRESS PLASTERBOARD PATRESS TO PLASTERBOARD WALL TO ENSURE BOND.
5. FIX THE PLASTERBOARD PATRESS TO THE PLASTERBOARD WALL USING MINIMUM 32MM LONG STEEL SCREWS. FIXINGS SHOULD NOT EXCEED 50MM FROM ANY EDGE AND NOT EXCEED 200MM CENTRES.
6. CUT 30MM DIAMETER POLYETHELENE BACKING ROD LONG ENOUGH TO WRAP AROUND THE PENETRATION AND SECURE ENDS OF THE ROD TOGETHER WITH ADHESIVE TAPE TO FORM A RING.
7. SLIDE THE BACKING ROD ALONG THE PENETRATION TO FORM A MINIMUM 25MM RECESS FROM FACE OF PLASTERBOARD.
8. FILL 25MM DEEP RECESS WITH INTUMASTIC HP (GREY) UNTIL FLUSH WITH PLASTERBOARD FACE.
9. REMOVE EXCESS INTUMASTIC USING A DAMP CLOTH.
10. OVERCOAT EXPOSED FIXINGS USING INTUMASTIC (WHITE).
11. REPEAT THE ABOVE TO THE OPPOSITE SIDE OF WALL.

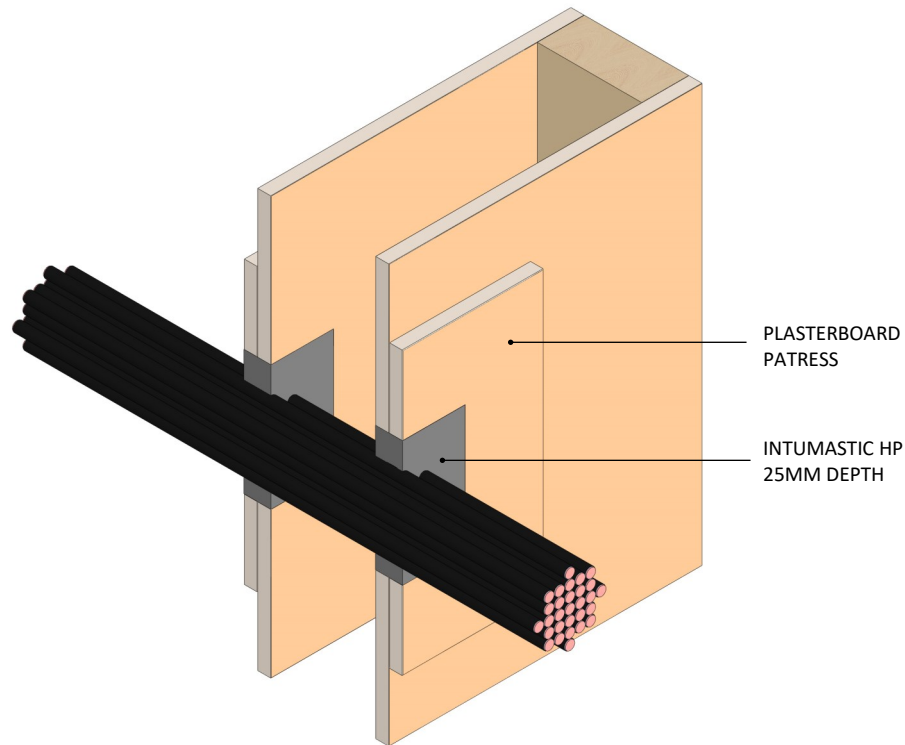

Products:	INTUMASTIC HP
Approval:	AS 1530.4/AS 4072.1
BK:	1 / 39
Ref:	35084000 / FAS190236
ID:	27/ V103
Scenario:	Penetration seal to cable bunch.
Annular:	10mm - 25mm.
Construction:	Gypsum / Masonry fire wall.
Aperture:	Up to 60mm x 60mm .
Fire Integrity:	60 minutes.
Insulation:	60 minutes.
Services:	12 no cables (max).

Please contact Ryanfire for specific cable bundle configurations.

Web based drawings are for example only, fire performance of any system is dependant on, but not limited to size of opening, substrate, if penetrations are passing through, type, size and number. Please refer to Ryanfire technical department for detailed and specific fire performance information.



Client

Job Title

Drawing Title

Intumastic HP to Cable Bunch - Plasterboard Wall

Scale	NTS	Date	July 2020
Sheet Size	A3	Drawn By	
Drawing Number	V26	Rev	2.0

Please note:
Ryanfire Products Ltd owns and has copyright in these drawings. They are to be used only for the purpose for which they were intended and supplied and are not to be sold, transferred or made available for use by a third party.

Any misuse of these drawings will result in legal proceedings.

All errors and omissions excepted - the Information contained within this drawing is believed to be correct on the date of publication, and is based upon tested and certified solutions. The policy of **RyanFire Products Ltd** is one of constant improvement. Installers must therefore ensure that they are following the latest published drawings, test evidence and instructions. Whilst **RyanFire Products Ltd** will endeavour to keep its publications up to date, the accuracy of the information contained within this drawing may be affected by pertinent changes in the law or regulatory requirements and alterations or amendments to the specification of the **manufactured** products. Terms and conditions of sale apply.

RYANFIRE Technical Support: info@ryanfire.co.nz - Tel 09 443 0362