

INSTALLATION INSTRUCTIONS

1. ENSURE THE APERTURE IS CLEAN AND FREE OF DUST AND DEBRIS
2. THE APERTURE MUST BE COMPLETELY LINED WITH 1 LAYER OF 13MM FIRE RATED PLASTERBOARD (FOR PLASTERBOARD WALLS).
3. APPLY RYANFIRE BRUSH GRADE MASTIC TO THE INTERNAL LINING OF THE APERTURE
4. SELECT THE CORRECT WIDTH OF RYANFIRE BATSPAN REQUIRED FOR THE VOID.
5. COMPRESS THE RYANFIRE BATSPAN AND FIT INTO THE VOID.
6. APPLY RYANFIRE MASTIC TO ALL BATSPAN JOINTS.

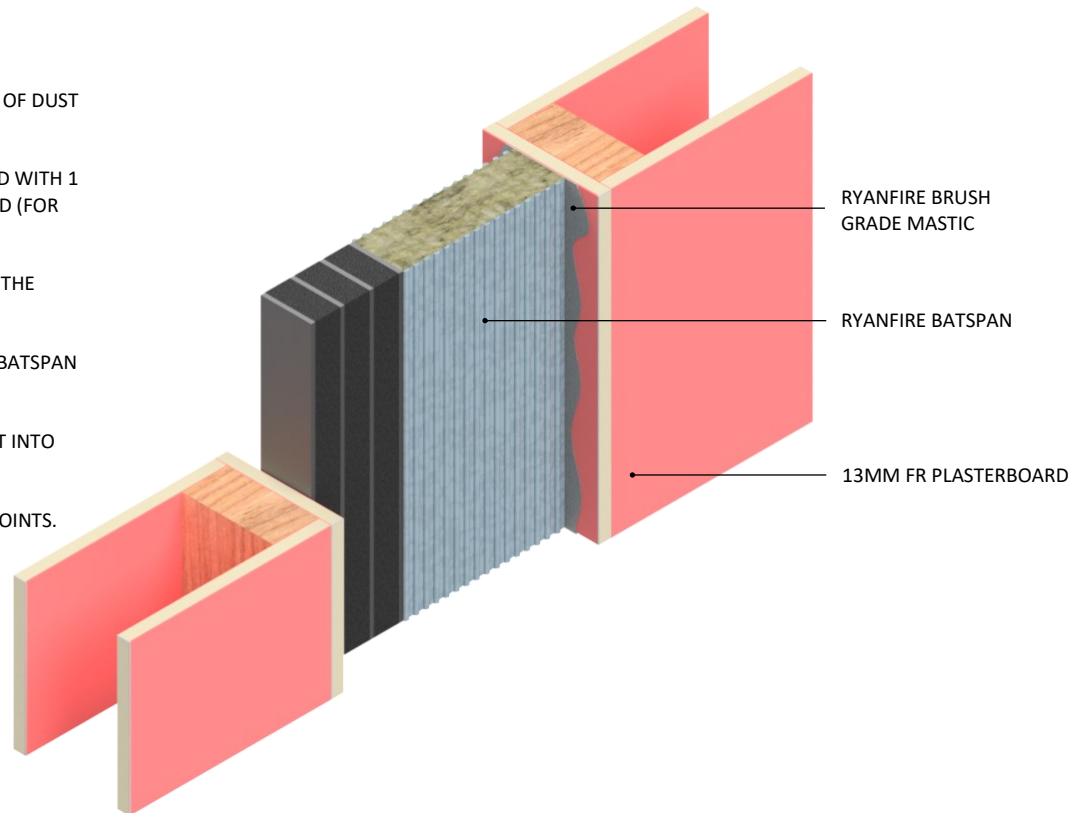

Products:	RYANFIRE BATSPAN RYANFIRE MASTIC RYANFIRE BRUSH GRADE MASTIC
Approvals:	AS 1530.4/AS 4072.1
BK:	82
Ref:	PF 19067
ID:	B
Scenario:	Linear gap seal
Construction:	116mm FR Plasterboard / Masonry wall Aperture completely lined with 1 layer 13mm FR plasterboard
Void Size:	250mm wide
Fire Integrity:	60 minutes
Fire Insulation:	30 minutes

Web based drawings are for example only, fire performance of any system is dependant on, but not limited to size of opening, substrate, if penetrations are passing through, type, size and number. Please refer to Ryanfire technical department for detailed and specific fire performance information.



Client

Job Title

Drawing Title

Ryanfire Batspan Vertical Seal 116mm Plasterboard Wall

Scale	NTS	Date	July 2024
Sheet Size	A3	Drawn By	
Drawing Number	V67	Rev	6.0

Please note:
Ryanfire Products owns and has copyright in these drawings. They are to be used only for the purpose for which they were intended and supplied and are not to be sold, transferred or made available for use by a third party.

Any misuse of these drawings will result in legal proceedings.

All errors and omissions excepted - the Information contained within this drawing is believed to be correct on the date of publication, and is based upon tested and certified solutions. The policy of **RyanFire Products** is one of constant improvement. Installers must therefore ensure that they are following the latest published drawings, test evidence and instructions. Whilst **RyanFire Products** will endeavour to keep its publications up to date, the accuracy of the information contained within this drawing may be affected by pertinent changes in the law or regulatory requirements and alterations or amendments to the specification of the **manufactured** products. Terms and conditions of sale apply.

RYANFIRE Technical Support: info@ryanfire.co.nz - Tel: 09 443 0362