

INSTALLATION INSTRUCTIONS

- 1. ENSURE THE APERTURE IS CLEAN AND FREE OF DUST AND DEBRIS
- 2. CUT THE RYANBATT 401 INTO STRIPS OF 150MM WIDE.
- 3. COAT THE UNDERSIDE OF THE TIMBER INFILL FLOOR WITH RYANFIRE BRUSH GRADE MASTIC, WHERE THE 401 WILL MATE WITH THE FLOOR.
- 4. APPLY BRUSH GRADE MASTIC TO THE UNCOATED FACE OF THE 401.
- 5. FIRMLY PRESS THE RYANBATT 401 AGAINST UNDERSIDE OF THE FLOOR TO ENSURE AN ADEQUATE BOND.
- 6. FIX THE RYANBATT 401 TO THE FLOOR USING MINIMUM 65MM STEEL SCREWS AND Ø25MM STEEL WASHERS ALONG THE CENTRE OF THE RYANBATT AT CENTRES NOT EXCEEDING 150MM, OR 30MM FROM JOINTS
- 7. APPLY BRUSH GRADE MASTIC TO ANY CUT AND EXPOSED EDGES OF THE 401 BOARD.
- 8. APPLY A 10MM BEAD OF RYANFIRE MASTIC TO THE JOINTS BETWEEN THE BOARD, FLOOR, AND THE WALL.
- 9. REPEAT THE ABOVE ON THE OPPOSITE SIDE OF THE WALL.

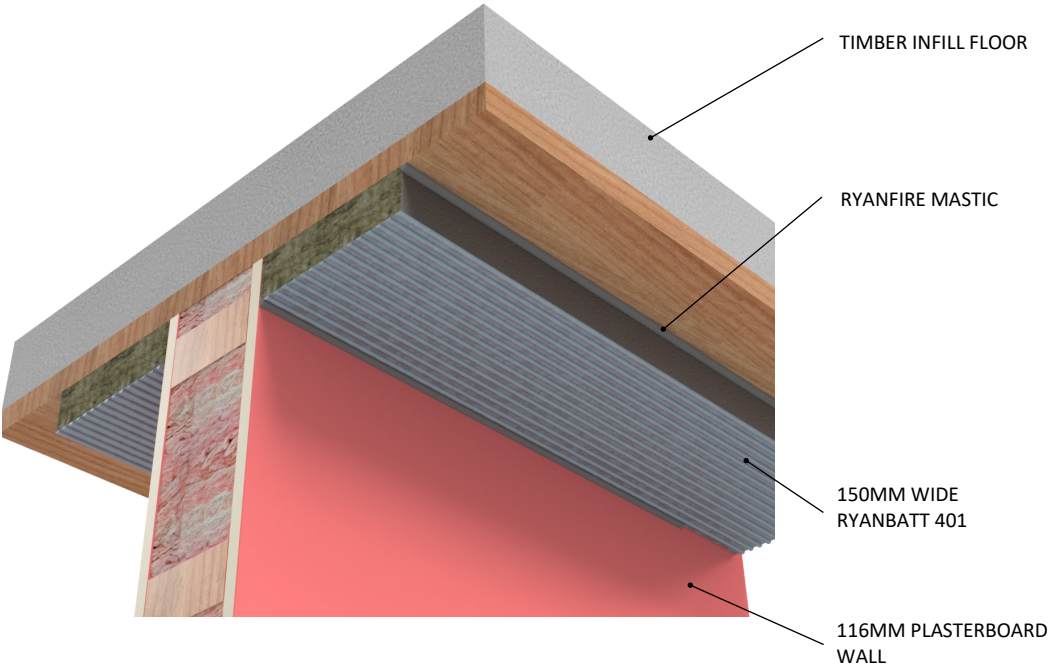

Products:	RYANBATT 401 RYANFIRE MASTIC RYANFIRE BRUSH GRADE MASTIC
Approval:	AS 1530.4/AS 4072.1
BK:	80
Ref:	FRT 200058
ID:	A
Scenario:	Head of wall junction
Construction:	FR plasterboard wall / Timber infill floor
Wall:	116mm FR plasterboard / Masonry
Floor:	100mm Timber infill
Fire Integrity:	60 minutes
Fire Insulation:	60 minutes

Web based drawings are for example only. Fire performance of any system is dependant on, but not limited to: size of opening, substrate, if penetrations are passing through, type, size and number. Please refer to Ryanfire technical department for detailed and specific fire performance information.



RYANFIRE Technical Support:
info@ryanfire.co.nz - Tel 09 443 0362

Drawing Title
Head-of-wall junction seal
116mm plasterboard wall / Timber infill floor

Scale	NTS	Date	October 2024
Drawing Number	V65	Rev	6.0

All errors and omissions excepted. The information contained within this drawing is believed to be correct on the date of publication, and is based upon tested and certified solutions. The policy of Ryanfire Products is one of constant improvement. Installers must ensure that they are following the latest published drawings, test evidence and instructions. Whilst Ryanfire Products will endeavour to keep its publications up to date, the accuracy of the information contained within this drawing may be affected by pertinent changes in the law or regulatory requirements and alterations or amendments to the specification of the manufactured products. Terms and conditions of sale apply.

Ryanfire Products owns and has copyright to these drawings. They are to be used only for the purpose for which they were intended and supplied and are not to be sold, transferred or made available for use by a third party. Any misuse of these drawings will result in legal proceedings.