

INSTALLATION INSTRUCTIONS

1. ENSURE THE APERTURE IS CLEAN AND FREE OF DUST AND DEBRIS.
2. CUT THE RYANBATT 502 TO THE REQUIRED SIZE AND SHAPE ENSURING THE RYANBATT 502 WILL OVERLAP THE PLASTERBOARD BY 50MM AROUND THE OPENING.
3. CUT THE RYANBATT 502 TO FIT TIGHTLY AROUND THE TIMBER PENETRATION.
4. APPLY RYANFIRE MASTIC TO THE PLASTERBOARD WHERE THE RYANBATT 502 IS TO BE FITTED.
5. APPLY RYANFIRE MASTIC BRUSH GRADE TO ALL RAW AND CUT RYANBATT EDGES.
6. FIRMLY PRESS THE RYANBATT 502 AGAINST THE PLASTERBOARD AROUND THE TIMBER PURLIN TO ENSURE AN ADEQUATE BOND.
7. FIX THE RYANBATT 502 TO THE PLASTERBOARD USING MINIMUM 75MM LONG STEEL SCREWS AND Ø25MM STEEL WASHERS. FIXINGS SHOULD NOT EXCEED 30MM FROM THE EDGE OF THE RYANBATT AT CENTRES NOT EXCEEDING 200MM.
8. APPLY RYANFIRE MASTIC TO THE JUNCTION BETWEEN THE RYANBATT 502 AND THE PLASTERBOARD WALL.
9. REPAIR ANY DAMAGE TO THE COATING WHICH MAY HAVE OCCURRED DURING INSTALLATION USING RYANFIRE BRUSH GRADE MASTIC.
10. REPEAT THIS PROCESS ON THE OPPOSITE SIDE OF THE WALL.

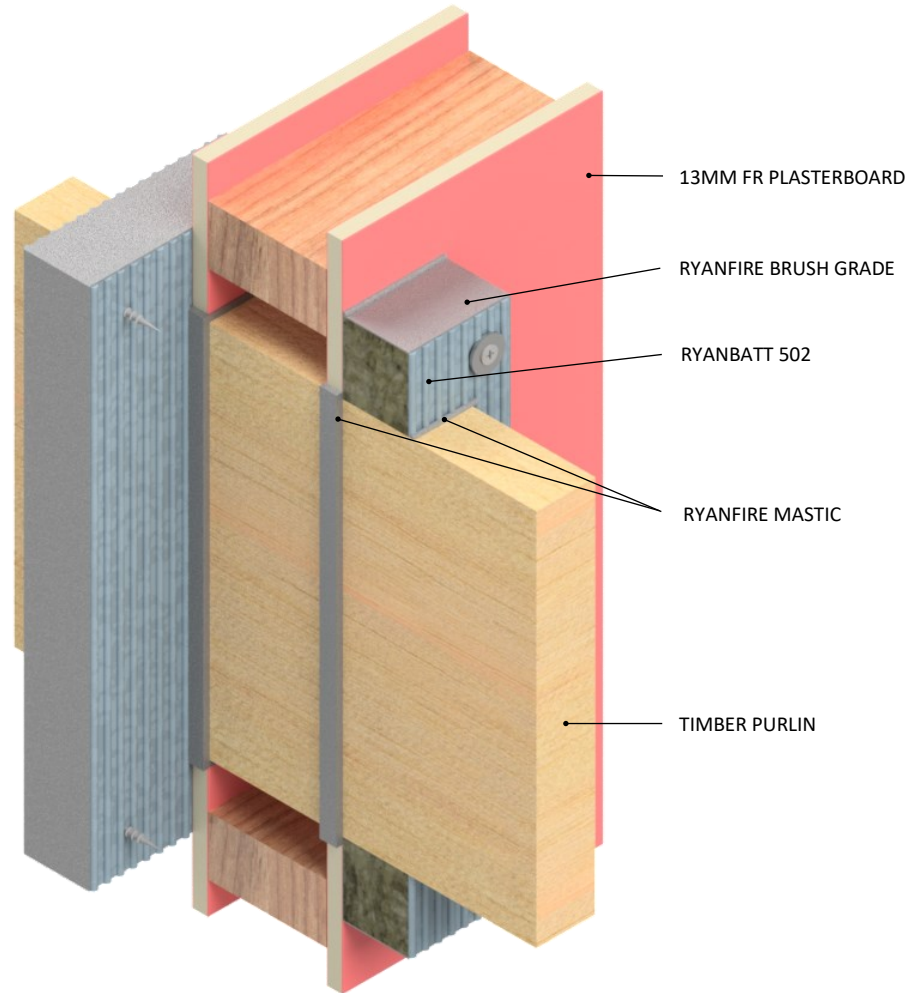

Products:	RYANBATT 502 RYANFIRE MASTIC RYANFIRE BRUSH GRADE
Approval:	AS 1530.4/AS 4072.1
BK:	80 / 33
Ref:	FRT 200058 / FAS 210123
ID:	D / Table 68
Scenario:	Timber purlin/beam through FR plasterboard wall
Penetration:	290mm x 45mm timber purlin
Construction:	116mm FR plasterboard / Masonry wall / Korok wall
Fire Integrity:	60 minutes
Fire Insulation:	60 minutes

Web based drawings are for example only. Fire performance of any system is dependant on, but not limited to size of opening, substrate, if penetrations are passing through, type, size and number. Please refer to Ryanfire technical department for detailed and specific fire performance information.



Client

Job Title

Drawing Title

Timber Purlin / Beam Plasterboard wall

Scale	NTS	Date	May 2022
Sheet Size	A3	Drawn By	
Drawing Number	V64.3	Rev	5.0

Please note:
Ryanfire Products Ltd owns and has copyright in these drawings. They are to be used only for the purpose for which they were intended and supplied and are not to be sold, transferred or made available for use by a third party.

Any misuse of these drawings will result in legal proceedings.

All errors and omissions excepted - the information contained within this drawing is believed to be correct on the date of publication, and is based upon tested and certified solutions. The policy of **RyanFire Products Ltd** is one of constant improvement. Installers must therefore ensure that they are following the latest published drawings, test evidence and instructions. Whilst **RyanFire Products Ltd** will endeavour to keep its publications up to date, the accuracy of the information contained within this drawing may be affected by pertinent changes in the law or regulatory requirements and alterations or amendments to the specification of the **manufactured** products. Terms and conditions of sale apply.

RYANFIRE Technical Support: info@ryanfire.co.nz - Tel 09 443 0362