

INSTALLATION INSTRUCTIONS

1. ENSURE THE AREA IS CLEAN AND FREE OF DUST AND DEBRIS.
2. ATTACH THE RYANTRACK TO THE METAL PROFILE TRACKING USING 48/50MM WIDE CLEAR CELLULOSE TAPE, ONE REVOLUTION AT EACH END AND ONE IN THE MIDDLE. ENSURE RYANTRACK IS MOUNTED CENTRALLY ON THE METAL PROFILE TRACKING. RYANTRACK SHOULD BE FOLDED DOWN OVER BOTH EDGES OF THE TRACK ON EITHER SIDE.
3. POSITION THE TOP TRACK ONTO THE BOTTOM SURFACE OF THE FLOOR AND FIX INTO PLACE USING PLASTERBOARD MANUFACTURER'S RECOMMENDED STEEL FIXINGS AT CENTRES NOT EXCEEDING 500MM.
4. INSTALL THE PLASTERBOARD OVER THE RYANTRACK WITH A 5MM OVERLAP, AND A 25MM GAP BETWEEN THE PLASTERBOARD AND THE FLOOR.
5. REPEAT THIS PROCESS ON THE OPPOSITE SIDE OF THE WALL.
6. THE PLASTERBOARD SHOULD BE FIXED ACCORDING TO THE MANUFACTURERS INSTALLATION INSTRUCTIONS.

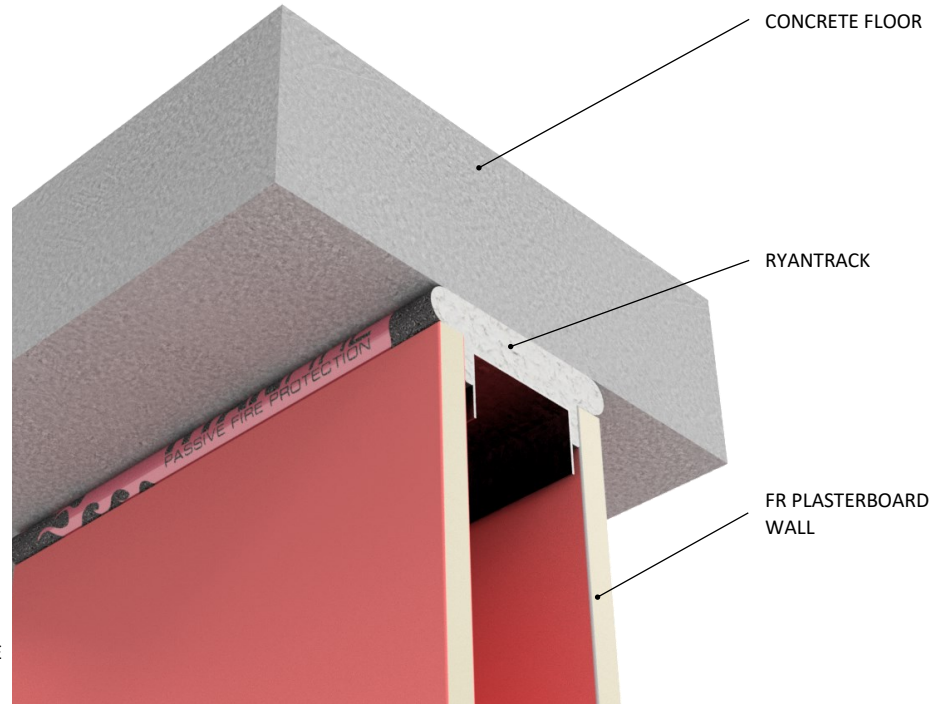

Products: RYANTRACK
Approvals: AS 1530.4/AS 4072.1
BK: 123
Ref: 21SFR00054
ID: F
Scenario: Head of wall / top track linear seal
Construction: 90mm FR plasterboard / Masonry wall
Gap size: 25mm
Fire Integrity: 30 minutes
Fire Insulation: 30 minutes

Web based drawings are for example only. Fire performance of any system is dependant on, but not limited to- size of opening, substrate, if penetrations are passing through, type, size and number. Please refer to Ryanfire technical department for detailed and specific fire performance information.



Client

Job Title

Drawing Title

**Ryantrack to head of wall linear seal
90mm plasterboard wall**

Scale NTS	Date May 2022
---------------------	-------------------------

Sheet Size A3	Drawn By
-------------------------	----------

Drawing Number V50.2	Rev 1.0
--------------------------------	-------------------

Please note:
Ryanfire Products Ltd owns and has copyright in these drawings. They are to be used only for the purpose for which they were intended and supplied and are not to be sold, transferred or made available for use by a third party.

Any misuse of these drawings will result in legal proceedings.

All errors and omissions excepted - the Information contained within this drawing is believed to be correct on the date of publication, and is based upon tested and certified solutions. The policy of **RyanFire Products Ltd** is one of constant improvement. Installers must therefore ensure that they are following the latest published drawings, test evidence and instructions. Whilst **RyanFire Products Ltd** will endeavour to keep its publications up to date, the accuracy of the information contained within this drawing may be affected by pertinent changes in the law or regulatory requirements and alterations or amendments to the specification of the **manufactured** products. Terms and conditions of sale apply.

RYANFIRE Technical Support: info@ryanfire.co.nz - Tel 09 443 0362