



## DESCRIPTION

The Ryanfire Power Pad is an intumescent rubber pad used for fire rating non-combustible electrical flush boxes within compartment walls on one or both sides of the wall.

The Power Pad will swell up when exposed to fire and will close up the flush box to prevent the spread of flame and hot gasses through the wall.

## CERTIFICATION

Ryanfire Power Pads have been tested and assessed in accordance with AS1530.4:2014 and AS4072.1:2005 at IANZ/NATA accredited laboratories.

## APPLICATION

Ryanfire Power Pads are suitable for NZ approved non-combustible flush boxes up to 95mm x 55mm x 50mm. Simply place the Power Pad into the flush box to rest against the back face.

## PRODUCT DIMENSIONS

Size : 70mm x 40mm x 4mm  
Colour : Black



Ryanfire Power Pad

Ryanfire Power Pads are used within various types of separating elements. Please contact the technical department for specific and more detailed "V" drawings.

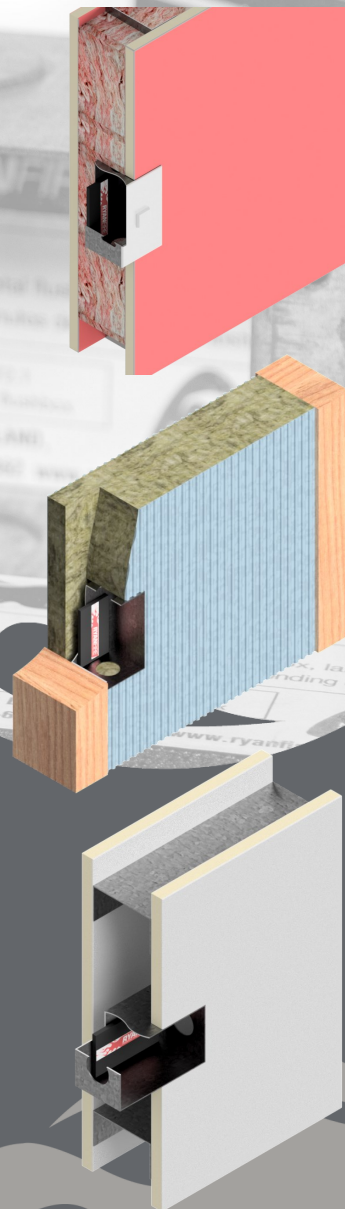

## FEATURES

- Tested to AS1530.4:2014
- Quick and easy installation
- Retro fit capable
- Up to 60mins FRR

The information provided in this document is issued in good faith. As part of Ryanfire Products ongoing product development and testing, we reserve the right to modify product specifications without notice. Any drawings given are for illustrative purposes only. Ryanfire Products accepts no liability whatsoever for any loss, damage or injury arising from the misinterpretation or misuse of the information given. Subject to our standard terms and conditions.



For more information please contact Ryanfire  
[info@ryanfire.co.nz](mailto:info@ryanfire.co.nz) 09 443 0362

Ryanfire TDS/PPD V1.3 08/2024